

Architecture in London

A variety of buildings

Architecture in London

Introduction of the exhibition

Presentation of the exhibition

London is not characterized by a single style of architecture. Indeed it is a city with both historical monuments and modern architecture which contributes to its charm.(RF)

Objectives of the exhibition

The aim of this exhibition is to show off the many impressive buildings in London.(RF)

Architecture in London

Introduction of the exhibition

Contents

P. 5 KING'S CROSS STATION

P. 9 ARCELOR MITTAL

P. 13 CITY HALL

P. 16 THE SERPENTINE SACKLER GALLERY

P. 20 OTHER BUILDINGS

King's Cross Station



Euston Rd, Kings Cross, London N1 9AL, United Kingdom
Gothic Victorian architecture
Built in 1852 by Lewis Cubitt and John McAslan
Owner : Network Rail

History and description of the building.

- King's Cross Station was built in 1852 by the architect Lewis Cubitt. The first King's Cross subway station was opened as part of the first section of the Metropolitan Railway in 1863 and redeveloped in 1868 and 1926. New underground subway platforms were opened 400 metres to the west in 1941 to facilitate exchanges with other lines. On November 18, 1987, the station was the scene of a devastating fire. The cause was attributed to an unextinguished match that had fallen, setting fire to an escalator, killing thirty-one people.



Why it is in our exhibition

- The station is a historic building both old and modern thanks to its rénovations. It almost became a legend thanks to Harry Potter.
- The name of the station comes from a monument of George IV.
- It attracts and welcomes a lot of people from all over the world.



Arcelor Mittal



Queen Elizabeth Olympic Park, London

Contemporary art

Built in 1852 by Anish KAPOOR and Cecil BALMONT

Owner: Olympic Park Legacy Company

Purpose: Olympic emblem / Observation tower

History and description of the building.

- This Tower was created in 2012 by Anish Kapoor and Cecil Balmont in the Queen Elizabeth Olympic Park. It was created for the Olympic Games of London in 2012 because it is their emblem. The tower is 115 meters high and is made of metal. We can visit it. The tower is in 2 colors, a red part and another, which is grey. Its style is special but interesting because of the wavy movement of the red part around the construction axis. The grey part looks like a spring. It's possible to get down of the monument in a slide.

Why it is in our exhibition

- This monument is beautiful because of its style and its difficulties of conception. The tower has an important role because it is as if it meant "we have welcomed the Olympic Games, it is a sport symbol.



City Hall



City hall
modern architecture
Built in by Foster and Partners
Purpose: town hall of London

Why it is in our exhibition

- It is a beautiful building, but it is expensive for what it is.
- City Hall is a beautiful building in London that serves as town hall, its location is ideal for directing London.

The Serpentine Sackler Gallery

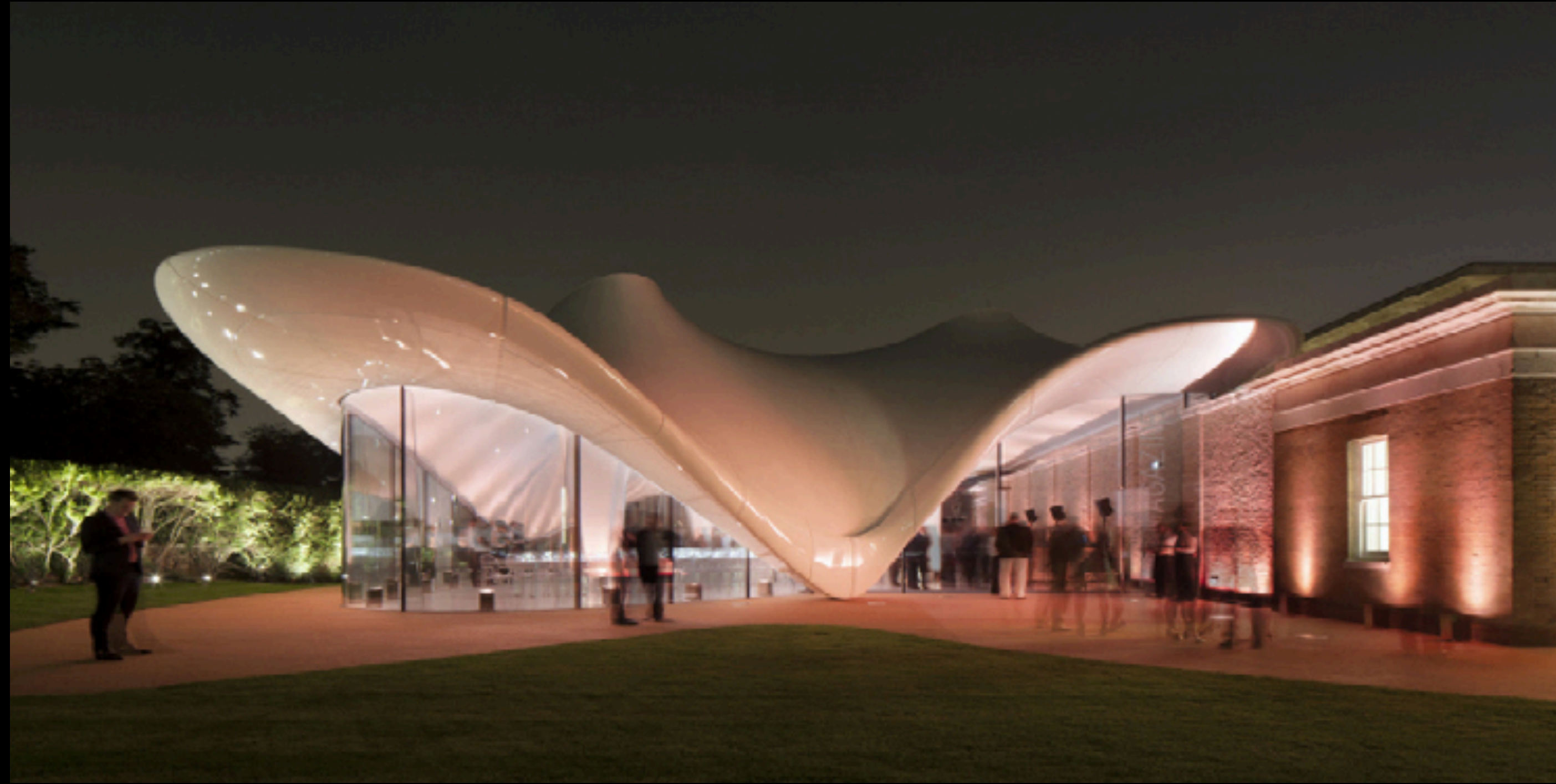

W Carriage Dr, London W2 2AR, United Kingdom
Transparent with a wave roof
Built in 2009-2013 by Zaha Hadid
Owner: Hans-Ulrich Obrist
Purpose: Art gallery

History and description of the building.

- The Serpentine Sackler Gallery was open in 2013. That give a new life of an old factory of gunpowder based in 1805 and called The Magazine. The Serpentine Sackler Gallery was extend by the architect Zaha Hadid who did a transparent building with a wave roof. It have 900 square metter of exposition, a restaurant and a store.



Why it is in our exhibition

- It is a very beautiful building, especially with the Zaha Hadid's extension. The choice of colors is very good and the conversation of the old building next to the extension is a good idea, because it is like a time travel between the 2 buildings.
- To conclude, I think it is a very good building for its history and its modern style especially with the extension. Zaha Hadid made a good job in the architecture of his art gallery. When I see that, I want to go in now !



Other buildings



Trellick Tower
Built in 1972 by Erno Goldfinger
Owner: Kensal Town



1 Poultry, London
Built by John Belcher



Strawberry Hill House
268 Waldegrade Rd, Twickenham
Neogothic
Built in 1749 by Horace Walpole



The Barbican Center, Leadenhall building (the Cheesegrater), M by Montcalm building, Cigarette factory



**Alexandra Palace,
Unilever London's headquarters,
Christchurch Spitafield, Leadenhall
market.**

CONCLUSION

The authors of this catalogue hope you enjoyed discovering these buildings and you understand why they attract people from all over the world.